



# SPOSgroup



## Petrol and Convenience Solutions

*"We design, make, procure, sell, manage and supply the products that sell your products"*

02 8667 4600  
sales@sposgroup.com



**Disclaimer:**

The information in this catalogue is the intellectual property of SPOS Group and is confidential, and intended solely for the Addressee. If you have received this information in error, please delete it immediately and notify the sender. Any copying or further distribution beyond the original addressee is not permitted, and may be unlawful. In receiving this information you agree that any intellectual property rights in the POP Goods, Services or Concepts contained within are and shall remain the property of SPOS.

# Poster Boards

## Wall Poster Frame

CODE: CRFB22

Hinged and Lockable Wall Poster Frame

Single Sided

WeatherProof

**Colour:** Black (Powder Coated)  
**Graphic Dimensions:** 1200 x 900mm



## Wall Lightbox Frame

CODE: CRFB23

Hinged and Lockable Wall Poster Frame. Lightbox built in (power required).

Single Sided

WeatherProof

**Colour:** Black (Powder Coated)  
**Graphic Dimensions:** 1200 x 900mm



## Non-Illuminated Garden Frame

CODE: CRFB24

Hinged and Lockable Non-illuminated Garden Frame

Double Sided

WeatherProof

**Colour:** Black (Powder Coated)  
**Graphic Dimensions:** 1200 x 900mm



## Solar Illuminated Garden Frame

CODE: CRFB25

Hinged and Lockable Illuminated Garden Frame

Double Sided

WeatherProof + **Solar Powered**

**Colour:** Black (Powder Coated)  
**Graphic Dimensions:** 1200 x 900mm





# Shelf Fronting Systems

## IMPROVE STORE PRESENTATION WHILE REDUCING MAINTENANCE & RE-STOCKING.

- The Roller Shelf System ensures products are always fronted to the shelf edge whilst reducing maintenance and re-stocking.
- 5 Year Warranty, durable long life fronting solution.
- Works at minimal shelf angles, as little as 3°, which requires less vertical shelf space.

**Pricing & Configuration on Application. Please contact SPOS.**

TO REQUEST A QUOTE AND SEE  
FLEXROLLER IN ACTION, VISIT  
[www.sposgroup.com/flexroller](http://www.sposgroup.com/flexroller)

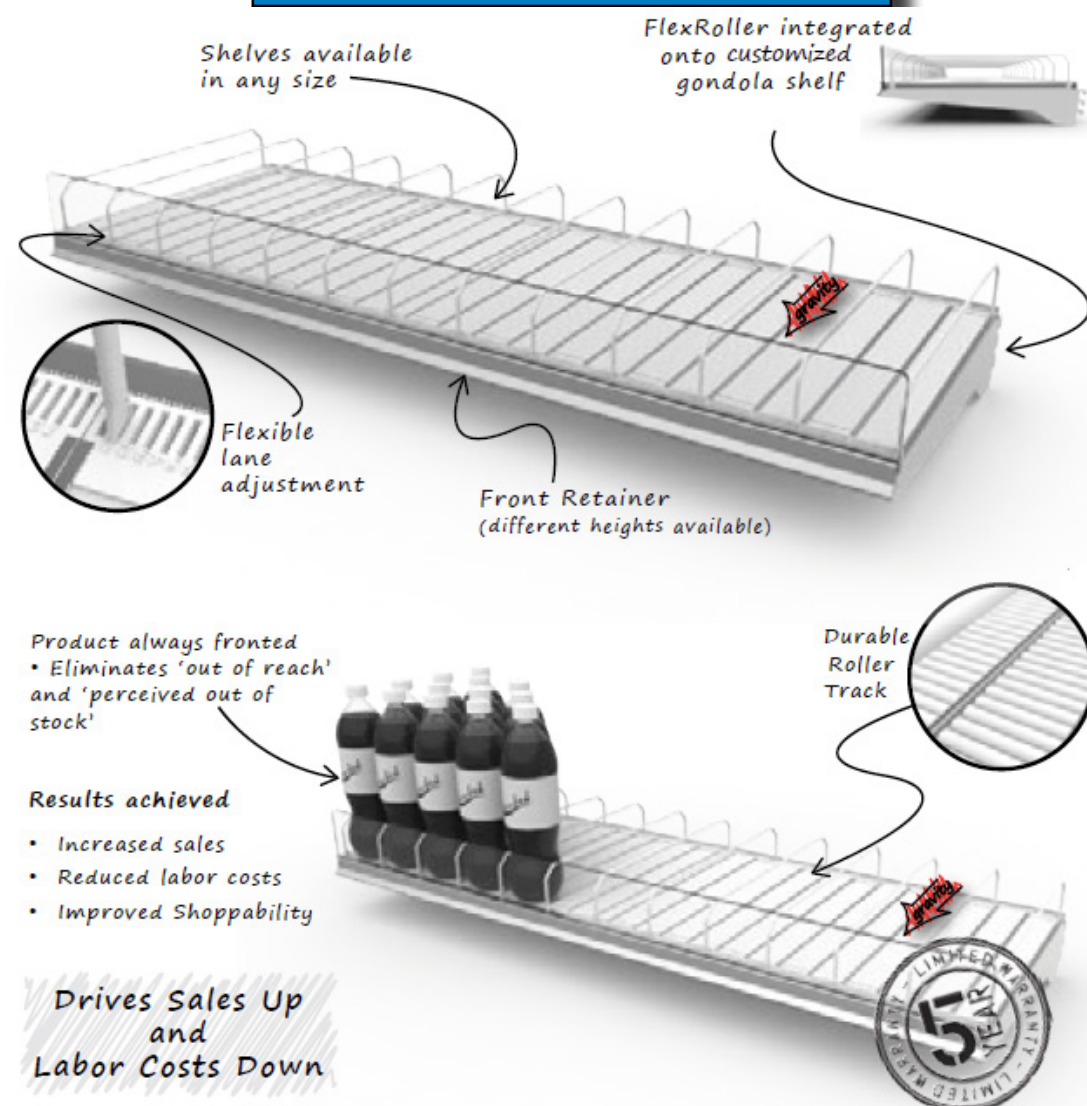

### Layover Glide

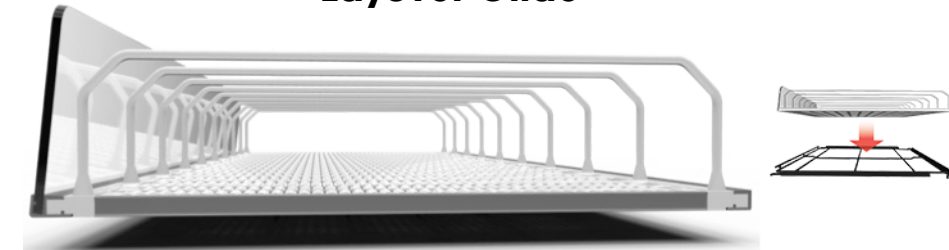

- The FlexRoller Layover glide installs on existing gondola or wire shelves.
- A minimum of a 3 degree angle is required for optimal performance of fronting product on the FlexRoller tray. Depending on product packaging details, a stepper angle (of ~6 degrees) may be beneficial.

### Gondola Shelf



- The FlexRoller Gondola shelf is customised to integrate into existing retailer gondola uprights
- The build-in bracket will create the perfect angle for optimum performance

### Riser Shelf

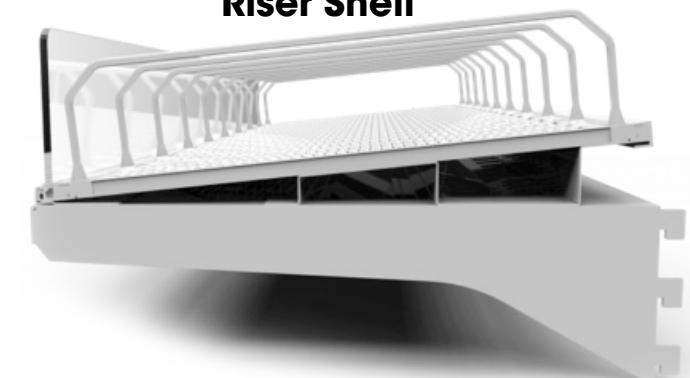

- The FlexRoller with Riser glide installs on existing flat gondola shelves.
- The riser accessory adds the optimal and stable angle that is required

# Shelf Fronting Systems

**ProGlide**  
Designed to Deliver

**Introducing ProGlide, a gentle fronting merchandiser.**  
**Controlled fronting motion that drives sales.**

- Controlled feed for multiple categories
- Fast and simple replenishment that saves labour
- Drives impulse purchases by keeping products front of facing.
- Modular planogram for complete flexibility on width
- Depth versatility from 270 to 770mm
- Easy installation with no tools required
- Eliminates the need for angled shelving, meaning no loss in vertical space.
- A gentle, quiet fronting merchandiser that eliminates the 'clanging' of bottles in drinks categories

**Pricing & Configuration on Application. Please contact SPOS Group.**

SEE IT IN ACTION!  
[www.sposgroup.com/proglide](http://www.sposgroup.com/proglide)

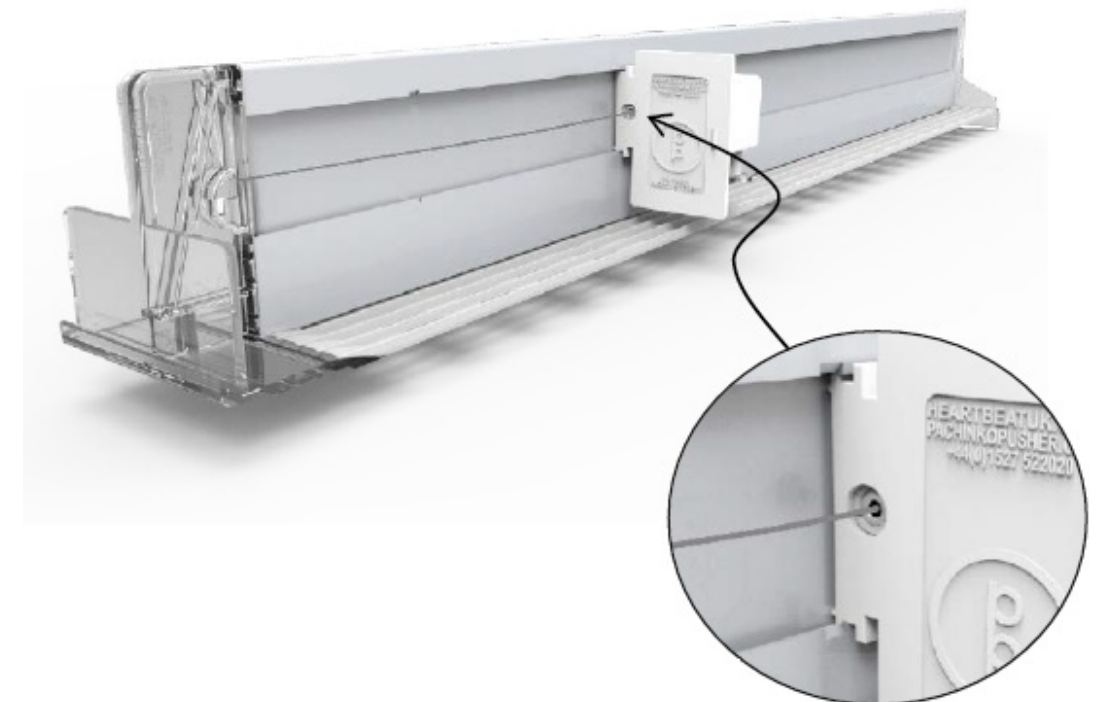
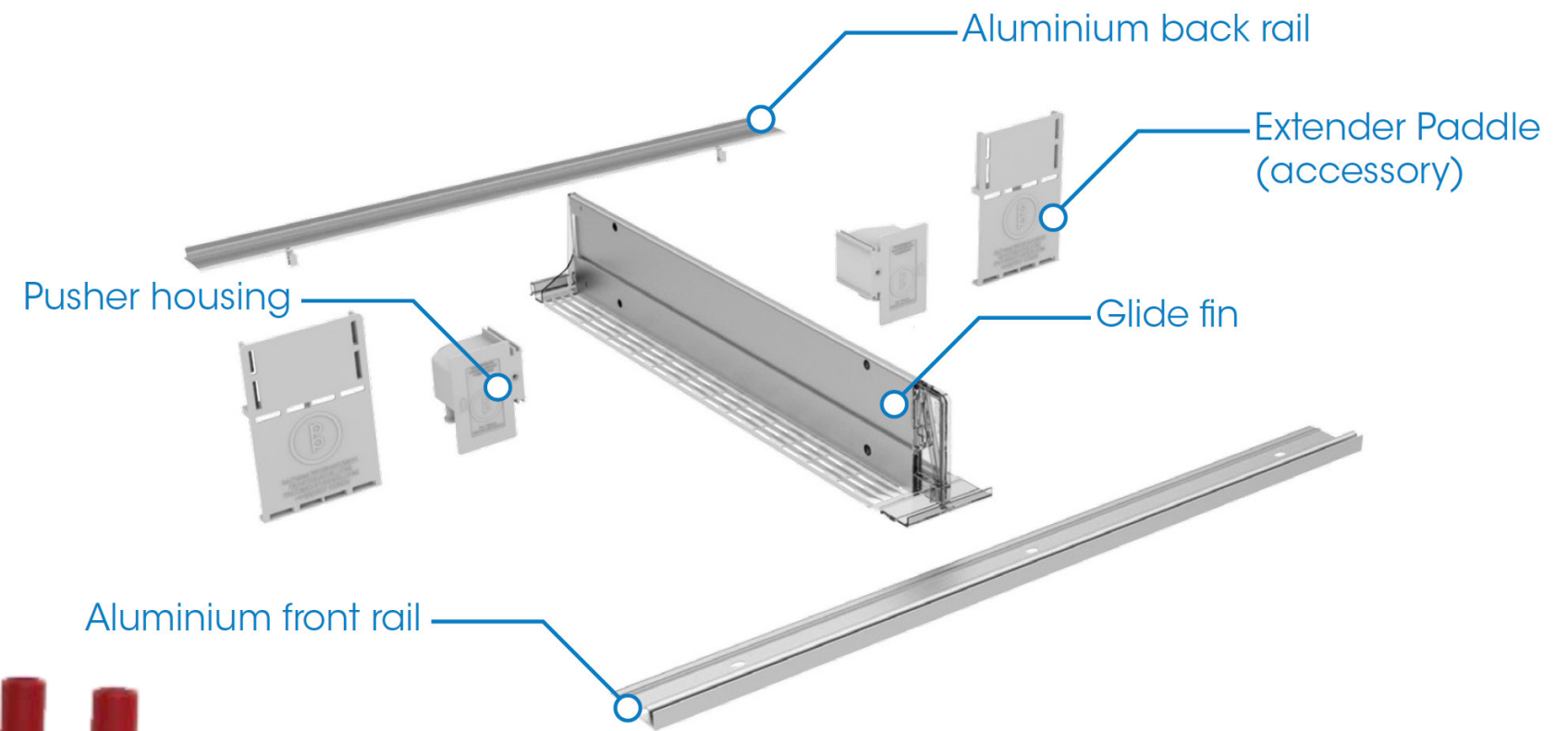
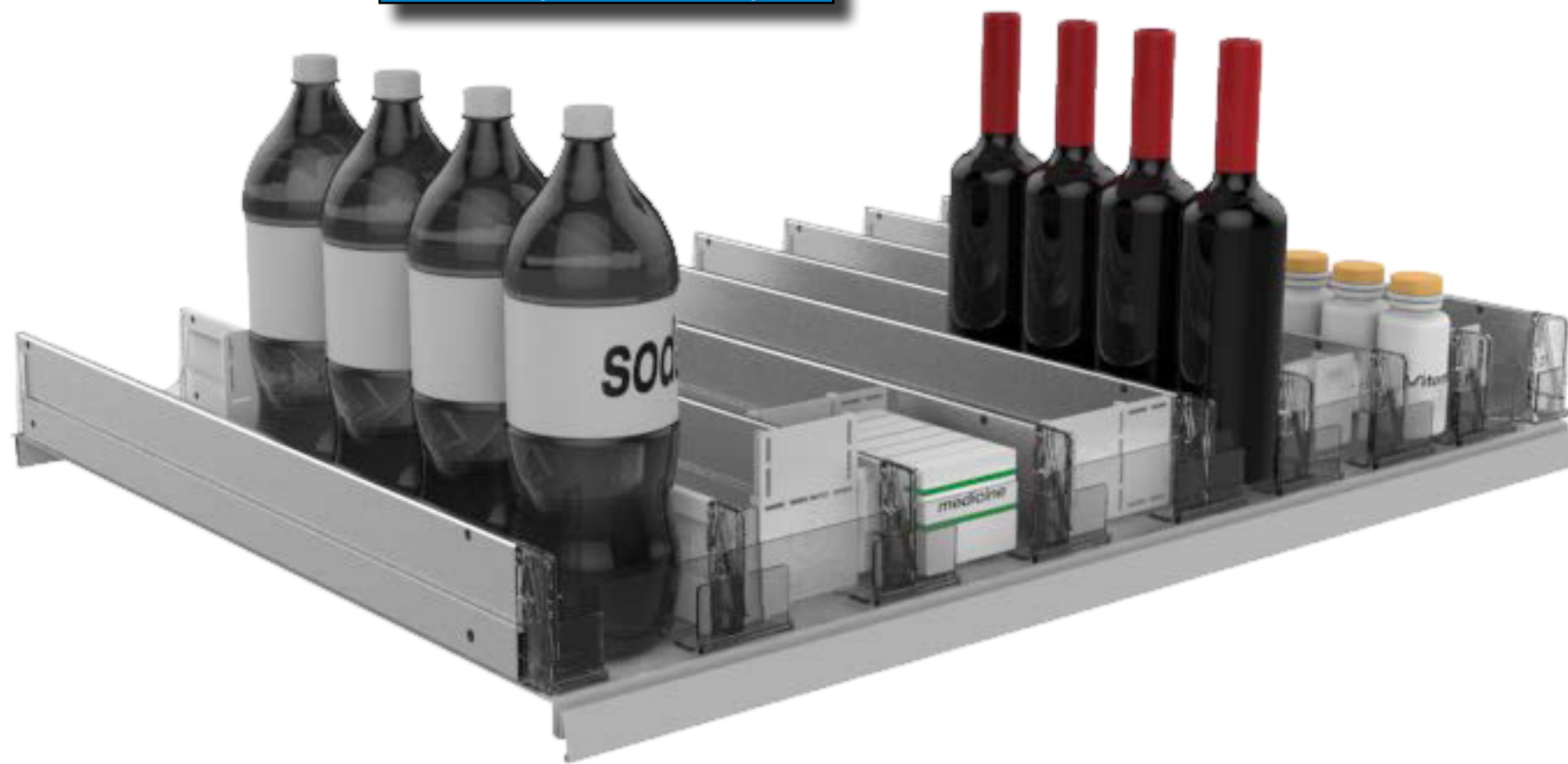



# Shelf Fronting Systems

**InterGlide, a modular interlocked fronting system...**  
**Gentle fronting motion with zero loss of facings.**

- Allowing efficient dividing of the category with ProGlide's 1.5mm dividers resulting in maximum facings per shelf.
- The front engagement system makes planogram adjustments and resets fast and easy.
- Modular lane assembly - complete flexibility on width
- Depth versatility - 350mm to 600mm
- Centralized bottom mounted pusher, lanes are consistent and parallel
- Easy installation with no tools required

**Pricing & Configuration on Application. Please contact SPOS.**

SEE IT IN ACTION!  
[www.sposgroup.com/proglide](http://www.sposgroup.com/proglide)

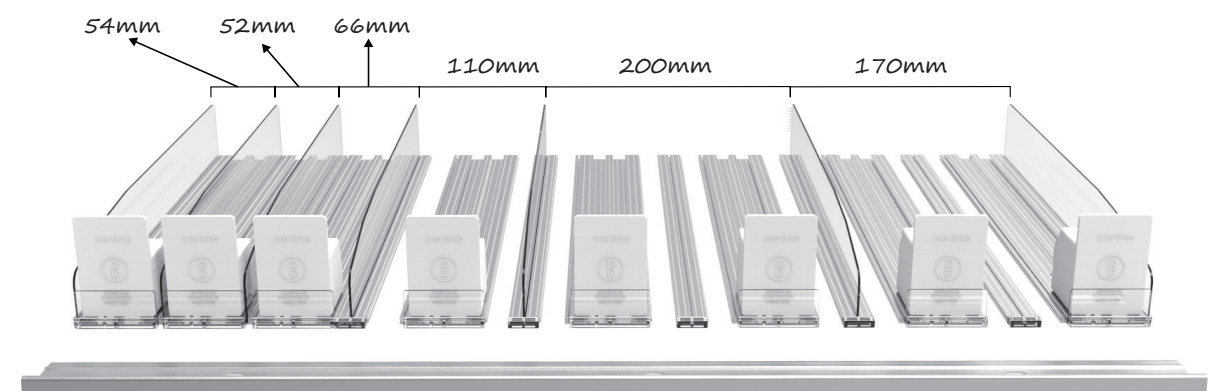
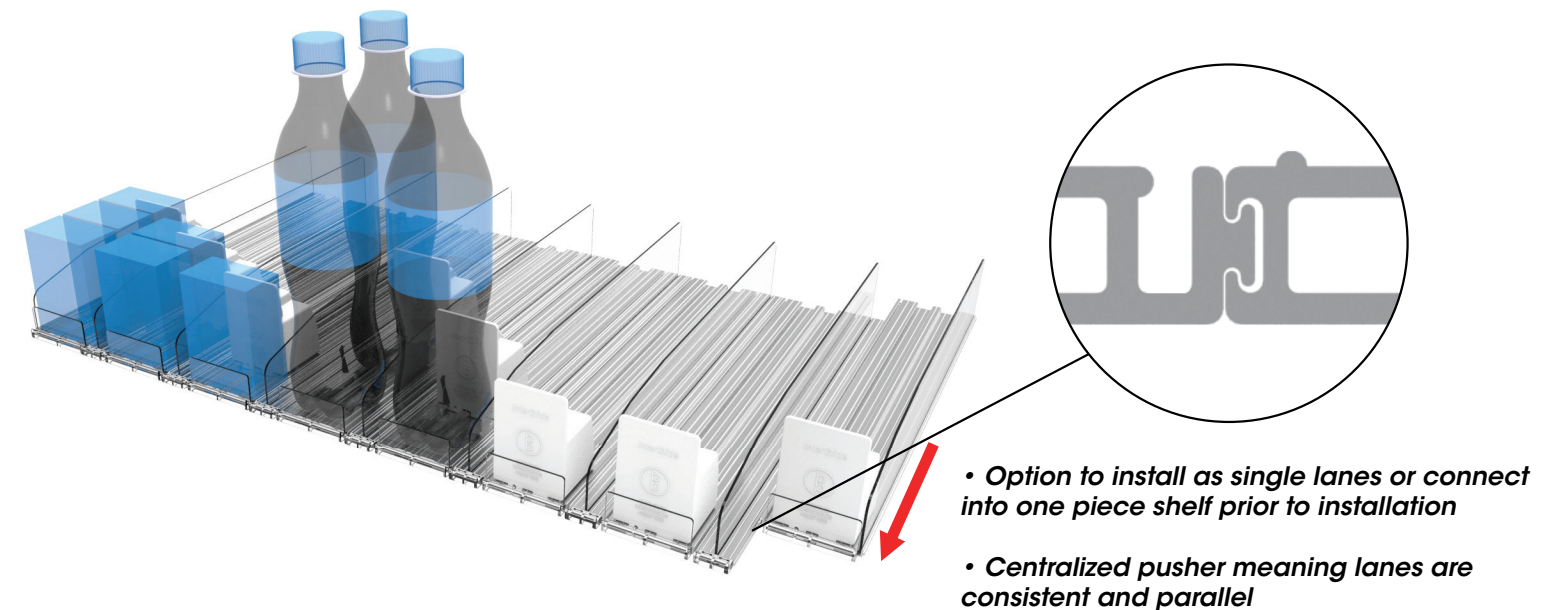
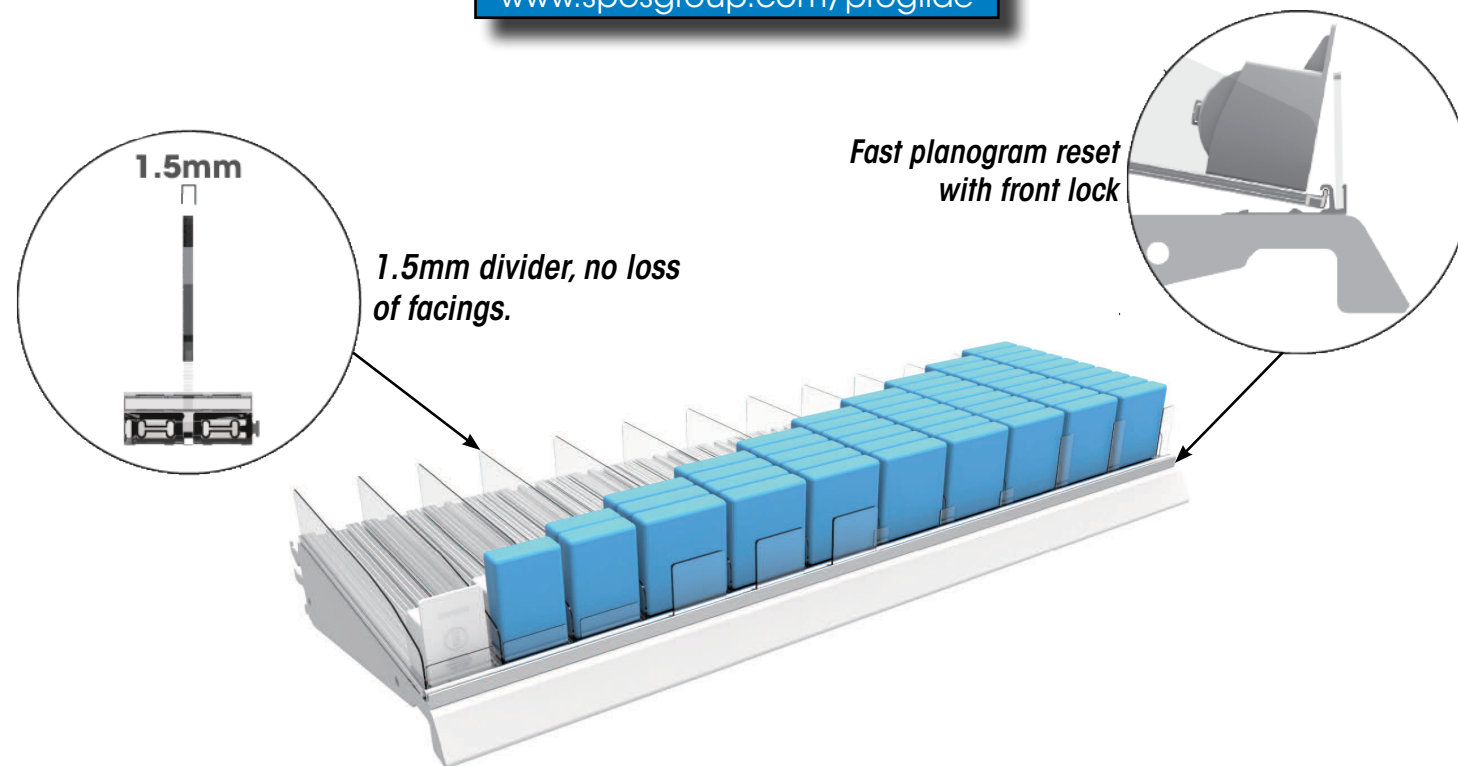

**InterGlide is so gentle & controlled, it can even front stacked cans. Enabling a high density shelf to be fronted seamlessly!**

# Data Strip

Wire Shelf Profile White

**CODE: MPRFCO-W700\***

Push on Data Strip profile 'wide' or 'narrow' mouth' for wire shelves.

**WIDE:**

Strip Height: 26mm  
Strip Length: 700mm  
Available Colours\*:

**CODE: MPRF-CO-W700WHITE**

**CODE: MPRF-CO-W700BLACK**

**NARROW:**

Strip Height: 26mm  
Strip Length: 660mm  
Available Colours\*:

**CODE: MPRF-CO-660WHITE**



Other Colours/Lengths Available - Please Enquire

'Fast Grip' Data Strip

**CODE: SF26FGT\*914**

Fast Grip Adhesive datastrip black. With grip for ticket inserts

26mm(H) x 914mm(L)  
Packs of 40

Available in Clear: **CODE: SF26FGTCL914**  
Black: **CODE: SF26FGTBL914**



CODE: SF26FGTBL914 - with price ticket

Also Available in **COLOURS**. Please Enquire

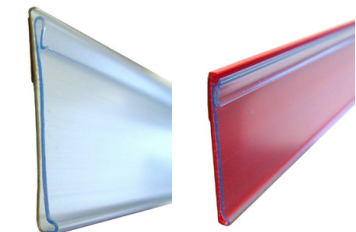

Data Strip

**CODE: DBR\*\***

Our DBR Data Strips are a quality, affordable data strip. Available for multiple ticket heights and strip lengths as well as colours.

Strip Height: 26mm, 39mm & more...  
Strip Length: 915mm, 1200mm & more...  
Available Colours: Black/Clear/White & more...

Code Examples:

**DBR26-TP-1200**

Clear, 26mmH Datastrip, 1200mm Long

**DBR26-TP-0915**

Clear, 26mmH Datastrip, 915mm Long

**DBR39-TP-1200BLACK**

Black, 39mmH Datastrip, 1200mm Long

Other Colours/Lengths Available  
Please Enquire

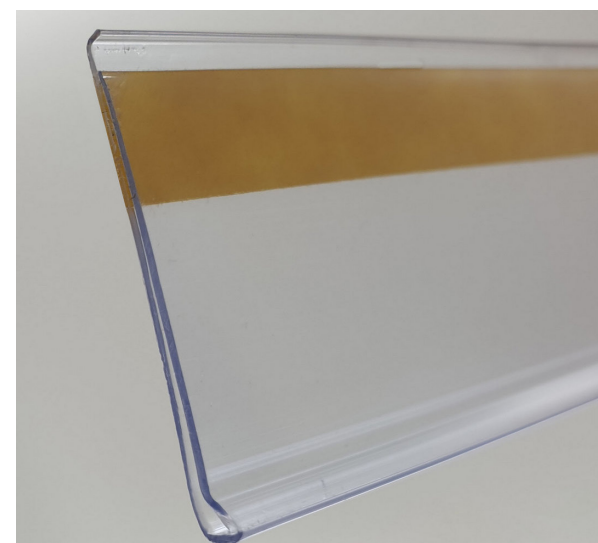

Data Strip - Provista

**CODE: SF26T\*\***

The Provista Adhesive Data Strip is made to last long term without fading/yellowing. Will last longer than standard datastrip, and has a clearer finish.

Strip Height: 26mm  
Strip Length Options\*: 914mm & 92mm  
Available Colours\*:

**WHITE**

Codes: **CODE: PSF26TWH92** - 92mm | White

**CODE: PSF26TWH914** - 914mm | White

Other Colours/Lengths Available - Please Enquire



Colours Available  
Please Enquire





# POS/Display Accessories

## Shelf/Gondola Barkers

CODE: SHELFB

Shelf Barkers for displaying 210mm x 77mm POS to help pop the pricing or a special deal  
**Pack Size: 20**  
**Also Available in "Large"**  
**CODE: SHELBL**  
80mm(H) x 420mm(L)



## Reduced to Clear Stickers

CODE: APP4503

Reduced for Quick Sale stickers.  
**Handwritten prices approved.**  
**Box Size: 250 stickers**



## 4 Tier Displays

Colours/Configs Available

**TYPE ONE**  
4 Tier Red Off Location Display - securable to Gondola Ends.  
  
New Design has:  
Reinforced Shelving  
Improved Ink (no fading)  
  
**Carton Contains: 2**



**TYPE TWO**  
4 Tier White Pop-Up Display  
  
- Assembles in Seconds  
- Can be packed down and stored when not in use.  
  
Watch Me In Action:  
[www.sposgroup.com/cardboard-displays](http://www.sposgroup.com/cardboard-displays)  
  
Please Enquire



## Pump Crowners

CODE: CRF100/101

Pump Crowners designed to be attached to fuel pumps with adhesive or magnetic tape.  
  
**Graphic Dimensions:**  
A4 Landscape (297 x 210mm)  
  
**Available Colours:** White  
  
**Codes:** **CRF100**  
A4 Pump Crowner Incl. PVC Sleeve.  
**CRF101**  
Replacement Sleeve Only (PETG)





# POS/Display Accessories

## Universal Mobile Unit

Please Enquire

The universal unit is designed to provide a Retailer or Brand with a re-usable, mobile merchandising unit that can be utilised anywhere in store, with the flexibility of changing each shelf configuration to suit what is being presented at shelf.

Custom designs and alterations available.  
Please enquire!



## Delta Hang Tabs

CODE: DADOCCE1C

Hang Tabs for hang sell products or repair broken hang sell packs.

- 38x44mm Tabs
- Hangs up to 400g weight

Pack Size: 8 Sheets of 24 Tabs

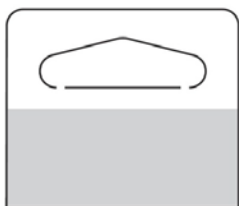

## Clear Parallel Clips

CODE: PWC

Promo Ticket Holder for Data Strips

Pack Size: 150



## POS Holder

CODE: CHCL798

POS holder with adhesive bottom and strong gripper to hold Long/Tall POS in Place.

Used primarily on Ice Cream Chest/Cabinet.

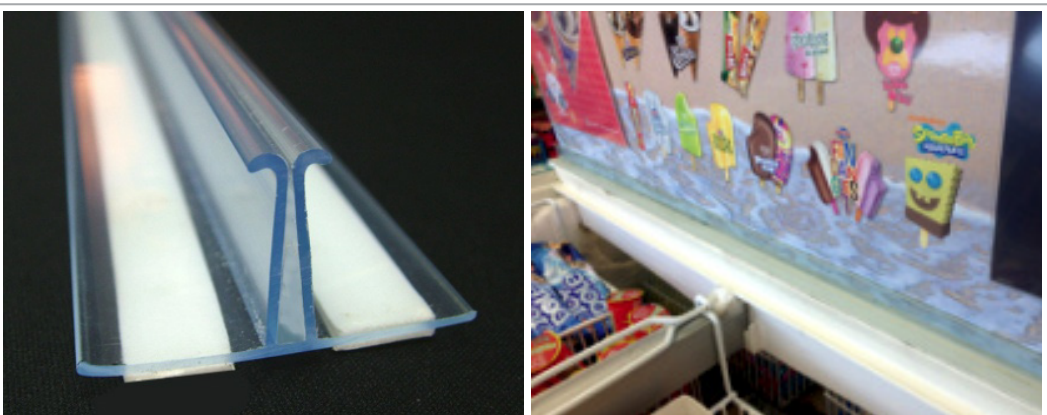

## POS Holder

CODE: ICC

Ice Cream Ticket holder, double sided with clip on bottom to clip onto wire in chest. Used primarily on Ice Cream Chest/Cabinet.

Pack Size: 40



## A3 Landscape Holder

CODE: A3LH

A3 Landscape Holder for Bulk Displays.

Pack Size: 6

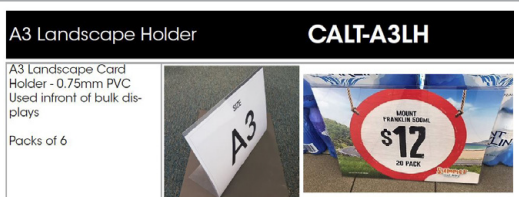
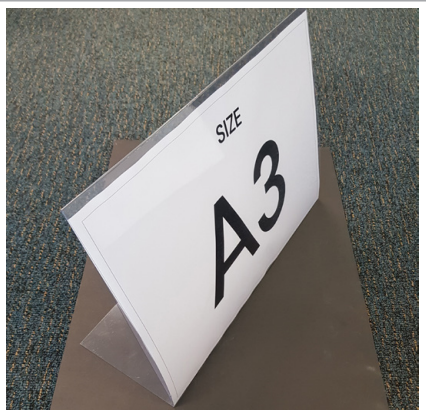



# Ticket IT

## In-Store Ticketing

### How it Works?

The complexity of your point of sale ticketing processes are simplified with Ticket-IT. We have automated, streamlined and simplified the entire POS ticketing process so all you need to do is focus on the profit.

SPOSgroup

SPOS Group has partnered with Ticket-IT to further compliment the comprehensive retail solution that the group offers. To learn more about the only ticketing solution ticking all the boxes, visit [www.sposgroup.com/ticket-it](http://www.sposgroup.com/ticket-it)

### Proposed Ticket Shell Suite Concept



Promo



Core Tickets



Clearance Tickets



Sale Tickets



### CONTROL

Ticket-IT provides the ability to control and manage in store ticketing effectively. Ticket-IT provides greater visibility, reduces the cost of lost opportunity and has a positive effect on store presentation.

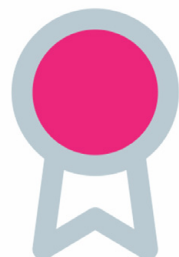

### CONSISTENCY

Ticket-IT removes the manual creation of tickets and the errors that occur with repeated human intervention. Ticket-IT delivers consistent and repeatable outcomes resulting in cost savings and a more efficient use of staff.



### CONFIDENCE

Ticket-IT gives confidence. This can reduce approval times, or eliminate proofing all together. Head office have the confidence that both stores and partners have the right information at the right time with the right branding.

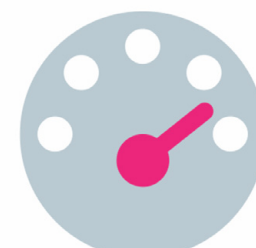

### SIMPLICITY

The process of printing, sending and then sorting through unwanted tickets is painful and complex. Ticket-IT automates the manual ticket production workflow delivering tickets within seconds, not days.

## The Bottom Line...

Less wastage

Staff efficiencies

Reporting system

Reactive pricing

Consistent, clear branding message

Better conversion



# Bakery Solutions

## Bakery Kit

**CODE: BAKEKIT**

The Bakery Kit offers a full kit of tools and kitchenwares for the convenience bakery.

**CODE: BAKEKIT Contents:**

1	Measuring Jug	<b>CODE: JUG</b>
1	Mesh Shaker	<b>CODE: SHKR</b>
2	Oven Mitt	<b>CODE: OVENMIT</b>
1	Pastry Brush	<b>CODE: PASTRY</b>
3	Tongs (stainless) 350mm	<b>CODE: SSTNG</b>
1	Whisk	<b>CODE: WHSK</b>
1	Chopping Board - White	<b>CODE: CCBW</b>
12	Melamine Trays	<b>CODE: FDS-MT2BK</b>

Please note the items with red **CODE:** code can be ordered seperately.

**CODE: FDSMT2BK**  
Melamine Display Tray (12)  
310mm x 280mm x 15mm



x12

## Bakery Ticket Holder

**CODE: BTH**

2 metal (stainless steel) clips on back of holder. Clear sleeve.

**Pack Size: 10**

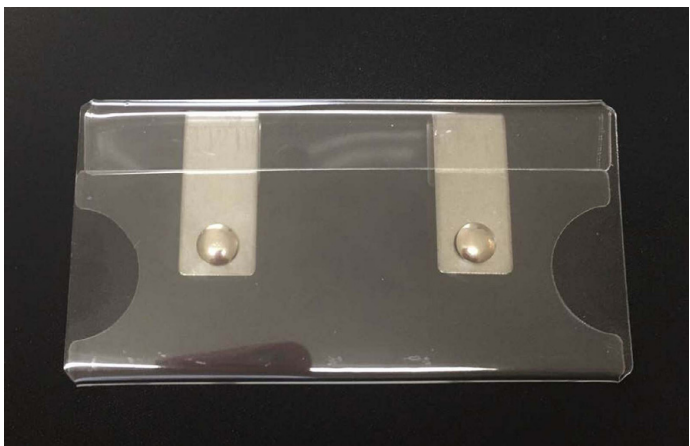

## Condiment Trays (Large)

**CODE: CTL**

Large condiment trays with 5 sections at rear for storage, and frames on front.

Suitable for slopped display cabinets.

**Dimensions:**  
900mmW x 310mmH  
x 250mmD



## Condiment Trays (Small)

**CODE: CTS**

Small condiment trays with 3 sections at rear for storage, and frames on front.

Suitable for slopped display cabinets.

**Dimensions:**  
600mmW x 310mmH  
x 250mmD



**In situ description:** These Cabinets have 2 CTL and 1 CTS side by side above the Curved front hot food cabinets.





# Bakery Solutions

Condiment Trays  
Cossiga Variant - (Large)  
**CODE: CTLC**

Large condiment trays with 5 sections at rear for storage, and frames on front.

Suitable for **Cossiga** heated display cabinets.

FRAME STICKS OUT ABOVE THE TOP OF ACRYLIC UNIT

ACRYLIC BASE FLUSH WITH FRAME AT BOTTOM

Condiment Trays  
Cossiga Variant - (Small)  
**CODE: CTSC**

Small condiment trays with 3 sections at rear for storage, and frames on front.

Suitable for **Cossiga** display cabinets.

IN-SITU **CODE: CTLC & CODE: CTSC**



Sandwich Risers  
**CODE: SR**

Used to better support sandwiches in the fresh food bar/chillers.

**Pack Size: 2**



# Aisle/Gondola Kits

## Gondola Frame Kit

**GES**

The Goldola frame kit provides up to 6 double sided callouts for products available in each aisle.

**CODE: GES Kit Contents:**

1	Metal T Bar
6	Double Sided Extrusions
1	Black Base
12	Clear Insert Covers



## Gondola Frame Inserts

**CODE: GSINKIT**

Inserts for the Gondola Frame Kit, this contains 66 name/label inserts (2 of each) to be inserted into the Frame Kit - double sided.

**CODE: GSINKIT Contents:**

Aisle Marker Inserts  
66x Names(2 of each for double sided)



**In situ description:** The in-situ image shows CODE: GES with CODE: GSINKIT (inserts) built together on a gondola aisle in.



## Gondola End Frame Kit

**CODE: GEFK\***

The gondola end frame provides two **A3** frames to put on the ends of each gondola. Magnetically attaches to Gondola

**CODE: GEFK Kit Contents:**

2	A3 Frames
4	T connectors
4	Extension tube sets (3 per)
4	90° clips

**Available Colours\*:**

**White - CODE: GEFKWT**



**Black - CODE: GEFKBK**

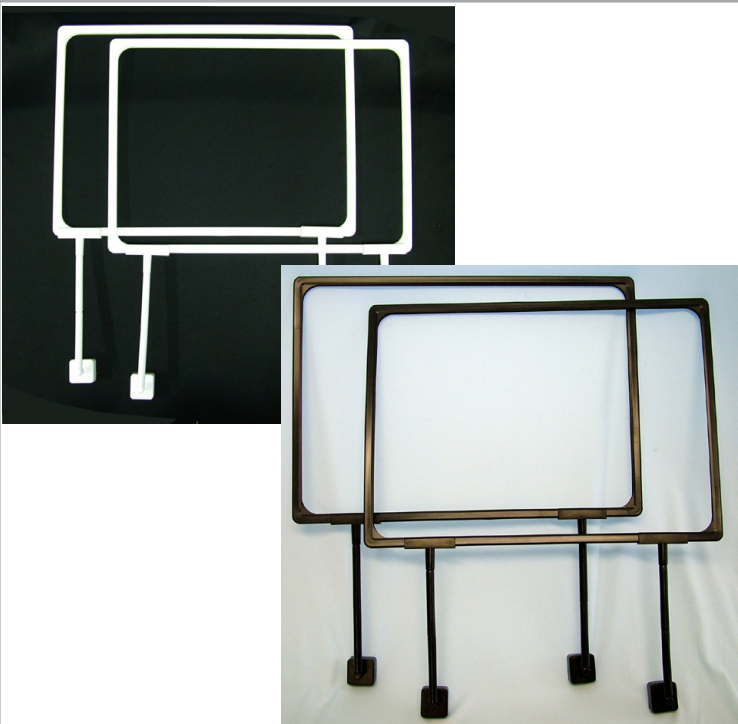

## Magnetic Signage Kit for Gondolas

**RAZZMAGSIGNKIT**

The Magnetic Signage kit comes with 2x magnetic 'Razz Bases', 2x 300mm gripper to hold the graphic in place & the 330x800mm double sided printed card.





# Frames and HC Display

Snap Frames

CODE: A#\*

Silver Snap Frames with multiple print sizes used in various locations within Store.

- A2 Code: **CODE: A2SFNH**
- A3 Code: **CODE: A3SFN**
- A4 Code: **CODE: A4SFC**
- A5 Code: **CODE: A5PCB**

Indent Available in A1 and A0. Please Enquire.

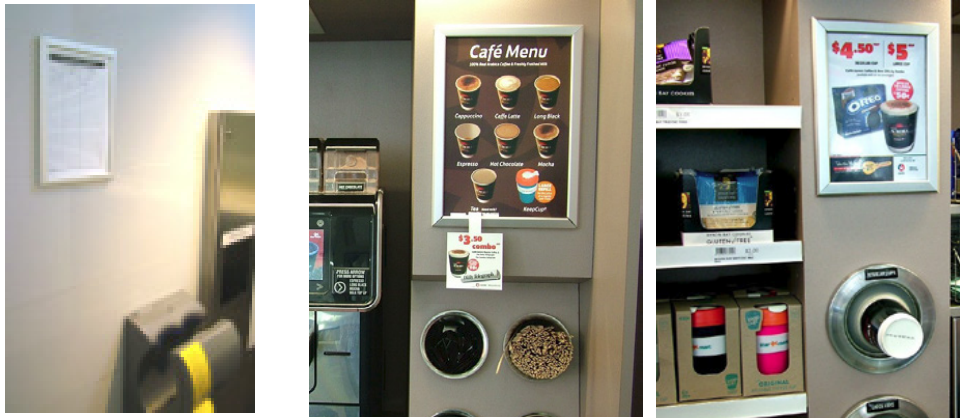
A4 Frame for jump wire (counter)

CODE: 1400WTF

A4 Frame designed for attaching to Jump Wire at counter - used for A4 Landscape signage.



A3 Counter Mat

CODE: M-MATA3

Long lasting A3 Counter Mat allows graphic insert to slide in from the top edge to be placed on counter.



A4 Duraframe

CODE: A4MAGP

Safety Frames Please Enquire

Magnetic A4 Duraframe often used for metal cabinets. Silver & Safety Frames Available

Pack Size: 2





A4 Card Holder

CODE: ADS5

Double Sided A4 Card Holder (Pack of 2)

Used for Casual Counter Signage

Pack Size: 2





Label Holders

CODE: HACPC#\*

PC Channel designed to hold tickets in hot cabinets for pies etc. Also suitable to ambient cabinets.

Available in Multiple Lengths:

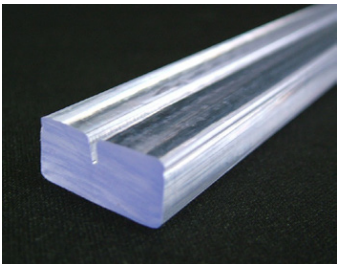
- \* 550mm(L) **CODE: HACPC6**
- \* 700mm (L) **CODE: HACPC7**
- \* 800mm(L) **CODE: HACPC9**

# Hooks and Flippers

Flipper Hooks



CODE: PGF\*

Flipper Hooks for hangsell products. Various lengths available

- \* 100mm (L)  
Code: **CODE: PGF2**
- \* 150mm (L)  
Code: **CODE: PGF3**
- \* 230mm (L)  
Code: **CODE: PGF5**
- \* 300mm (L)  
Code: **CODE: PGF6**

Without Flipper

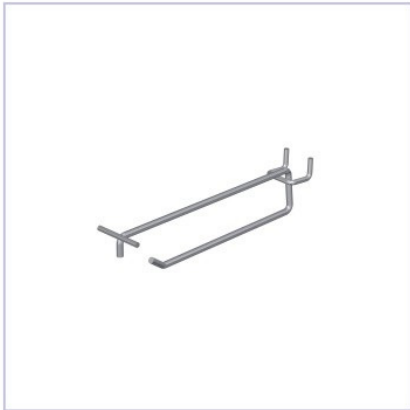
With Flipper

Flippers

CODE: HH2\*

Flippers are 80mm(W) x 26mm(H) & easy to attach to the hooks. Available in colours:

- \* Clear  
Code: **CODE: HH2CL**
- \* White  
Code: **CODE: HH2WH**
- \* Black  
Code: **CODE: HH2BK**





Prong Hooks

CODE: PGS\*

Standard Hooks for Volcano/PunchPanel, 4mm Diameter. Varying Lengths.

- \* 100mm (L)  
Code: **CODE: PGS2**
- \* 150mm (L)  
Code: **CODE: PGS3**
- \* 230mm (L)  
Code: **CODE: PGS4**



**Please Note**

Carton Size for all hooks: 50 Hooks

Pack size for all flippers: 50 Flippers

Anti-Sweep Hook

CODE: ANTISWEEPFSHOOP380-TRPDOR-ASSY

Anti-Sweep Flipsan Hoop Hook 380mmL Chrome with TrpDor & Data Strip.

Designed to allow one stock item to be shopped at a time, preventing sweeping of stock.

Price/Detail on Application. Please Enquire with us!







**Wide Rang of Hooks Available**

SPOS Supply a range of hook types and lengths. Just send us an image or enquiry of what you're after and we will supply it.

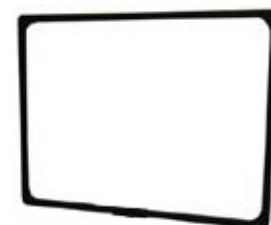

# Bulk/Pallet Displays

<b>Pallet/Plinth Display Kit</b>	<b>CODE: PWDKIT</b>	<b>A3 Frame Stand Kit</b>	<b>CODE: PWDSTD</b>
<p>Traditionally used for the NuPure Water Bulk Display, this kit comes with 4 black plinths that connect to each other to create a pallet for the water to be placed on.</p> <p>A black A3 Frame and Frame stand are included in the kit.</p> <p><b>Kit Includes:</b> <b>CODE: PWD Base</b> <b>A3 Frame &amp; Stand</b></p>		<p>Traditionally used for the NuPure Water Bulk Display, this kit comes with 4 black plinths that connect to each other to create a pallet for the water to be placed on.</p> <p>A black A3 Frame and Frame stand are included in the kit.</p> <p><b>Kit Includes:</b> <b>A3 Frame &amp; Stand</b></p>	
<b>Black Pallet/Plinth</b>	<b>CODE: PWD</b>	<b>A3 Black Frame</b>	<b>CODE: PF1300B</b>
<p>The black bases can be purchased as standalone. Useful for creating other forms of raised bulk display, water, toilet paper, washing detergents ETC.</p> <p>CODE: A3LH is often used alongside the bulk displays.</p> <p><b>CODE: PWD comes with 4 plints &amp; clips to join them all together.</b></p> <p><b>Single Plinth: 120 H x 300 W x 400 D mm</b> <b>x4 Plinths: 120 H x 600 W x 800 D mm</b></p>		<p>A3 Black Frame only.</p>	
<b>Black Stand</b>	<b>CODE: PF2006B</b>		
<p>Black Stand Only</p> <p>Frames can be clipped to the top of the stand.</p>			

# Printers/Tapes & Labellers

## Brother P-Touch Printer

CODE: PT450

For printing P-Touch labels for use in various areas around the store, including price updates in Bakery cases.

\*printer model subject to change as per manufacturer updates



## Meto Date Labeller

CODE: METO-DATE-LABELLER

Meto 7.22 Date Labeller

(New Date Labeller - Implemented Beginning 2019)



## Meto 'Use By' Labels

CODE: METO-UB-LABELS

22X12 FN "USE BY" Black on White Adhesive

Pack Size: 20 Rolls  
Roll Size: 1500 Stickers

For Meto 7.22 Date Labeller



## TZ Label Tapes

CODE: TZ (tapes)

P Touch Label Tape

12mm - Black on Clear  
Code: **CODE: TZ131**

12mm - White on Clear  
Code: **CODE: TZ135**

18mm - White on Black  
Code: **CODE: TZ345**

BLACK ON CLEAR

WHITE ON CLEAR

WHITE ON BLACK



## Meto Replacement Ink Rollers

CODE: METO-IROLLER

Meto Replacement Ink Rollers (store in cool area out of sun)

Pack Size: 5 Rollers per Pack



## Sold Out Sticker

CODE: OOTSK

Store 'Sorry Sold Out' stickers





# MISC Accessories

## Fresh Food Riser

**CODE: FRESHFRISER**

This product helps to better present and organise fresh food offerings. Designed for fridges.

- Sold as 'Each'

- Dimensions:

175MM(W) x

220MM(H) x

230MM(D)

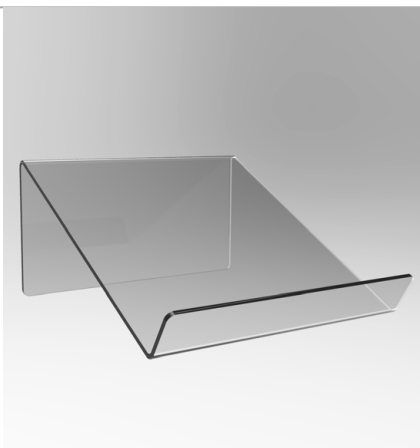

## Superlux Grip Mat

**CODE: SUPERLUXTH/1M/BLK**

Grip mat by the meter.

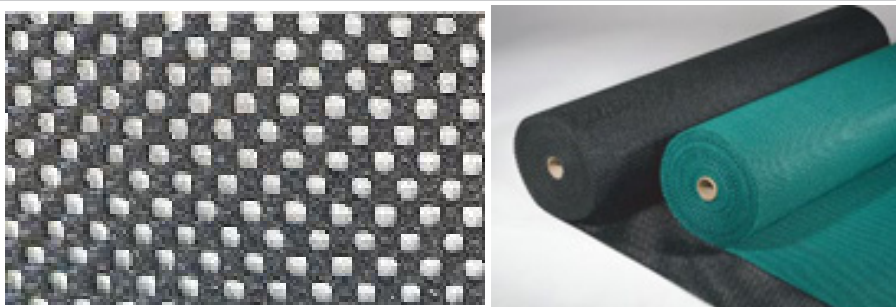

## SHELF BARKER SIGN HOLDER

**CODE: SIGNHOLD608-100**

Shelf barker sign holder  
25 mm wide with super grip

**Pack Size: 10**

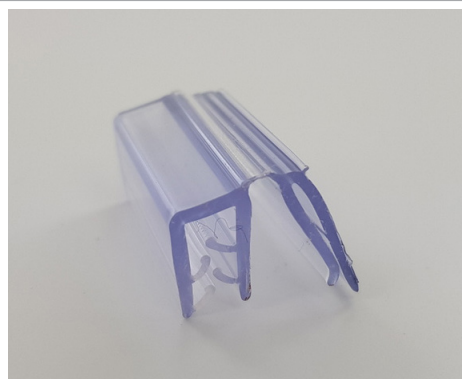

## Banana Basket

**CODE: BANBSKT**

Hanging Fridge Basket  
for Bananas.

Powder Dipped Metal



## Pull Basket

**PULLBASKET-ORANGE**

ORANGE PULL ALONG  
BASKET

**Carton Size: 6**



# MISC Accessories cont.

Stainless Steel Ticket Clip

CODE: TA-TB2SS

Stainless steel clip for use in a hot bain marie or tray. food ticket attaches to top.  
  
(Food Ticket: CODE: BT-H2)

Pack Size: 10



Black Food Ticket

CODE: BT-H2

65 x 88mm Food Ticket (Black) - Attaches to stainless steel ticket clip. (above)  
  
Sold as 'Each'



Food Ticket 65 x 88mm  
Black

Hang Sell Strip

SELLSTRIP12BLACK

This 12 station hang-sell strip is designed to be attached to the upright of a gondola, or other flat surface.  
  
Up to 12 products can then be hung from the strip.  
  
Sold as 'Each'





# Ice Cream Freezers

## Ice Cream Tray - Polycarbonate

**CODE: ICTPOLY**

**IN SITU**

Ice Cream Trays provide sections for individual ice creams in upright freezers, stopping the different ice creams from getting mixed or falling off the shelf. Made from strong & clear polycarbonate.

350mm(Depth) on all trays, width is custom.

Common Widths:

- 710mm (MASLEN Freezers)
- 600mm (SKOPE VF650X Freezers)

~2week lead time

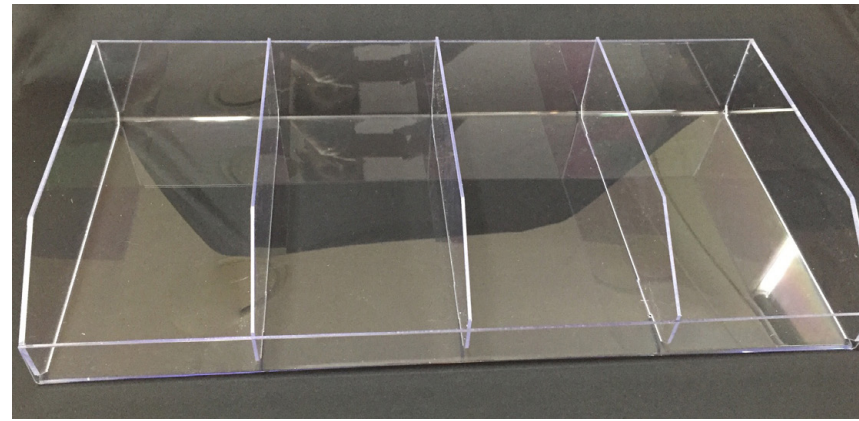

## Vinyl Curtain for Ice Cream Freezers

**CODE: ICCCURTAIN**

Ice Cream Curtain is designed to hide the unsightly bottom of the freezer from customers view.

600mm(H) x 700mm(L)

Is supplied cut down to fit to freezers.



## Ice Cream Clip

**CODE: ICC**

Ice Cream Clips clip onto the wire inside of the Chest Freezers, and provided a double sided slot for ticket pricing of the ice creams.

Packs of 40





# Miscellaneous

Business Card Holder

CODE: BCHCT6

Horizontal business card holder clear.

Sales Multiple x1



A4 Card Holder

CODE: ADS5

A4 Vertical Double Sided card holder. Used to hold various A4 inserts.

Sold as 'Each'



Table Stand 50mm

CODE: TRR050

Table stand with metal ring. For displaying fresh product prices & info in cabinets.

50mm(H)



Carry Baskets  
Basket Stand

CODE: DBMHBLPHBK  
CODE: DBMBS

Carry baskets for customers who need more than a few items.

Recommended 10 Baskets per Stand

Carry basket stand with castor wheels.



Image shows Stand and Baskets

Table Stand 300mm

CODE: TRR300

Table stand with metal ring.

Used in bulk fruit/food displays for pricing or deal callout

300mm (H)



Single Oven Mitt

CODE: OVENMIT

Ovenmit for Bakery Serving





# Our Service to YOU

## Online Catalogue

You can visit our website to download the latest catalogue at any time!

### Simply Visit:

[www.sposgroup.com/our-catalogue](http://www.sposgroup.com/our-catalogue)

## Brand & Retailer Challenges

Should you come across anything that needs fronting, signage, calling out or merchandising - please don't hesitate to get in contact with any of us at SPOS.

### General Enquiry

[sales@sposgroup.com](mailto:sales@sposgroup.com)  
02 8667 4600

SEE OUR WEBSITE FOR MORE CAPABILITIES

[www.sposgroup.com](http://www.sposgroup.com)